

# High Voltage Diodes - Surface Mount

150mA - 500mA • 70ns

## ELECTRICAL CHARACTERISTICS AND MAXIMUM RATINGS

Part Number	Working Reverse Voltage (V <sub>rwm</sub> )	Average Rectified Current (I <sub>o</sub> )		Reverse Current @ V <sub>rwm</sub> (I <sub>r</sub> )		Forward Voltage (V <sub>f</sub> )		1 Cycle Surge Current t <sub>p</sub> =8.3ms (I <sub>fsm</sub> )	Repetitive Surge Current (I <sub>frm</sub> )	Reverse Recovery Time (3) (T <sub>rr</sub> )	Thermal Impd. θ <sub>J-L</sub>	Junction Cap. @50VDC @1kHz (C <sub>j</sub> )	Markings
		55°C(1)	100°C(2)	25°C	100°C	25°C	25°C	25°C	25°C	25°C	25°C	25°C	
	Volts	mA	mA	µA	µA	Volts	mA	Amps	Amps	ns	°C/W	pF	
SXF6521	2000	500	250	0.5	20	3.0	500	25	5	70	7.0	8.0	6521
SXF6523	3000	250	125	0.5	20	5.0	250	15	3	70	7.0	4.0	6523
SXF6525	5000	150	75	0.5	20	7.0	150	10	2	70	7.0	3.0	6525

(1)TC=55°C (2)TC=100°C (3)I<sub>f</sub>=125mA, I<sub>r</sub>=250mA, I<sub>rr</sub>=63mA \*Op. Temp.= -65°C to +175°C Stg. Temp.= -65°C to +200°C



Part	A	B	C
SXF6521	.240 ±.010 (6.10 ±.25)	.200 ±.005 (5.08 ±.13)	.130 (3.30)
SXF6523 SXF6525	.280 ±.010 (7.11 ±.25)	.240 ±.005 (6.10 ±.13)	.170 (4.32)

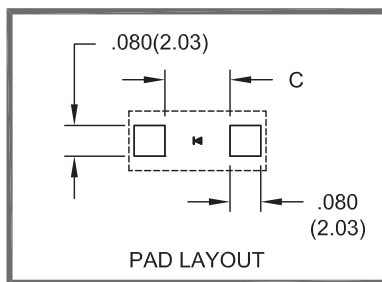

Tolerance:  
.XXX ±.005

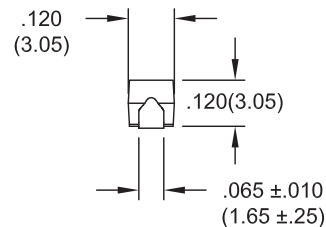
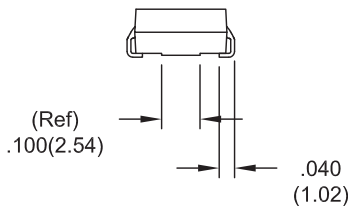
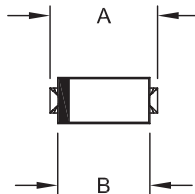

Dimensions: In. (mm) • All temperatures are ambient unless otherwise noted. • Data subject to change without notice.



Voltage Multipliers Inc.

8711 W. Roosevelt Ave.  
Visalia, CA 93291 USA

Tel: 559.651.1402  
Fax: 559.651.0740

[www.voltagemultipliers.com](http://www.voltagemultipliers.com)  
[www.highvoltagepowersupplies.com](http://www.highvoltagepowersupplies.com)

# SXF6521 SXF6523 SXF6525

1

